

THE NEXT GENERATION OF HI-FI



BOXing Clever



AUDIOTUNING Ges.m.b.H. · Margaretenstraße 98 · A-1050 Vienna, Austria  
Phone: +43 1 544 85 80 · Fax: +43 1 544 85 80-33 | e-mail: info@project-audio.com · http://: www.project-audio.com



Responsible for content: Heinz Lichtenegger · Artwork & photography: groovedesignSTUDIO, Vienna  
Not responsible for printing errors · Subject of change without notice.

THE SMART WAY TO LISTEN TO HI-FI · BOX-DESIGN PRODUCTS 2010

# INTRODUCTION

## BOX DESIGN PRODUCTS

Over more than 20 years, Pro-Ject Audio Systems has earned a worldwide reputation for excellent but reasonably-priced turntables, which revolutionised the analogue market. Simple but highly-functional designs with high-quality materials, together with excellent sound quality, are the trademarks of Pro-Ject Audio Systems. Now we have assigned the same principles to the new Box Design series of high quality electronic products.

## PREMIUM COMPONENTS

All enclosures are made from die-cast metal, with brushed aluminium faceplates – 100 % resonance optimised and stable. No plastic! Interior components were selected for their audiophile properties, especially in the high-end SE-series. Computer-optimised circuit boards and SMD-technology (Surface Mount Device) are used for best sonic quality and short signal paths. All connectors are gold-plated for the preservation of signal quality and were selected for their superior connectivity.

## SOUND QUALITY

“Less (features) = more (music)”: Clever circuit layout, short signal paths, the best components and the application of progressive digital technologies make it possible to achieve sonic qualities that you would not expect at this price level. Intensive listening tests determine the final choice of all components.

Pro-Ject Box Design products have an open, airy, lifelike sound with great timbre and loads of detail. We feel that high end sound is not merely a matter of high sound-pressure-level and broad dynamics: it is about the emotion in music becoming a reality in your home.

## EUROPEAN MANUFACTURING

To implement new ideas into practice and to guarantee highest possible standards in workmanship, all of our products are “Made in Europe”. The advantage of fabrication facilities within the European Union are evident: Reliable communication with European partners, qualified personnel and short distances are mandatory for both the best quality and protection of our environment.

## AMAZINGLY LOW PRICE LEVELS

Pro-Ject Box Design products are not cheap, but because of their top-quality they represent astonishing value. To achieve such sensible price levels, we had to overturn current thinking about the costing principles of electronic products. Typically, 70% of an electronic unit (amp, CD player, etc) is paid for its housing and only the remaining 30% is budgeted for the components inside. We think that you should pay for the functionality you need, which is why we produce large quantities of minimalist, common-to-all housings for our equipment. Therefore we are able to reduce expenses drastically and leave 80% for the components that really matter. Another highly important part of cost reduction is the removal of unnecessary features. Many of today’s electronic products offer functions that you have to pay for and but rarely use. With the modular concept of Box Design, you only buy what you really need. That is why the customer gets more sound quality from Pro-Ject Box Design components for a small investment!

## WHY PRO-JECT BOX DESIGN?

You may ask yourself, why did Pro-Ject, the world’s No.1 manufacturer of audiophile turntables, launch their own series of audio electronics using the latest digital technologies? The answer is to give as many music lovers as possible the chance to benefit from a cost-saving entry to the audiophile world!

## YOU NEED TO KNOW ...

the background from which Pro-Ject Audio Systems originated. Heinz Lichtenegger, founder of Pro-Ject Audio Systems, was the owner of a small, specialised hi-fi shop in the 1980s. It was his intention was to get best sounding equipment for limited budg-



ets. His customers, many of whom became his friends, typically purchased a system consisting of a small “audiophile” amplifier, a pair of speakers – usually stand-mounted – and an analogue turntable, which was far better than recent CD players. By the end of the 1980s, however, prices for quality turntables seemed to double when compared to only a few years before. So Heinz Lichtenegger had to manufacture his own alternative, and the now-legendary “Pro-Ject 1” became reality. Despite the passage of many years, numerous systems from that time are still providing musical pleasure for their owners. Some of them have been exchanged for more expensive high-end systems to meet the demands of ambitious music-lovers.

Now the audio world has changed radically, with iPods and computerised systems dominating the audio market. It seemed to Heinz that general knowledge about the virtues of a real hi-fi-system was disappearing.

But he did not surrender! Confronting poor-sounding digital radios, iPod systems and even worse micro-sized surround systems, Pro-Ject Audio Systems continues to fight for high audio-standards, while knowing that this battle will not be won by standard, archaic, often-expensive 440 mm equipment!

## MODERN PRODUCTS ARE ...

small, smart, functional, easy to use and reasonably priced. If you add audiophile sound quality, you have a Pro-Ject Audio product – a perfect match of modern lifestyle and superior music reproduction. Pro-Ject Box Design proves to be the ideal bridge between the new “iPod Generation” and real audiophile commitment. Pro-Ject BOX-Design products are made for ordinary people, who look for premium audio gear that is compact and easy to use. As in the 1980s, you can create a personal high-end audio system, but now with micro-sized components like Pro-Ject PRE-Box, AMP-Box, TUNER-Box, DOCK.Box and/or USB-Box. But better than the 1980s: you will get a system worthy of the ambitious audio enthusiast for a budget price!

## AND ANOTHER THING ...

All amplifiers and components in the Pro-Ject Box-family offer the highest standards in audio reproduction, therefore demanding that only high quality loudspeakers (like SPEAKER-Box 5) should be considered. We strongly recommend listening tests before purchasing, so that you will find the best partnering speakers. The available output power of our components should be more than sufficient for standard living rooms, in combination with most of the loudspeakers available.

If you wish, we will be pleased to recommend dealers with the facilities for appropriate listening tests!

## TABLE OF CONTENTS ...

AMPLIFIERS .....	4
AMPLIFIERS – SE SERIES .....	5
AMPLIFIER & RECEIVER-Box .....	6
SOURCE COMPONENTS – DOCK-Box, TUNER-Box .....	7
SOURCE COMPONENTS – CD-BOX .....	8
D/A CONVERTERS – DAC-BOX, USB-BOX .....	9
PHONO-PREAMPLIFIERS .....	10
PHONO-PREAMPLIFIERS .....	11
ACCESSORIES .....	12
HEADPHONE AMPLIFIERS .....	13
ACCESSORIES .....	14
ALL-IN-ONE PHONO SYSTEM .....	15
LOUDSPEAKERS .....	16
CABLES .....	17
HI-FI RACKS .....	18
TECHNICAL DATA .....	19
SYSTEM COMBINATIONS [1-6] .....	21
SYSTEM COMBINATIONS [7-10] + MULTIRoom .....	22



THE SMALLEST AUDIOPHILE AMPLIFIER at the world market — figure with CD album in original size



# AMPLIFIER

## PREBOX · AMPBOX stereo · AMPBOX mono

### PRE BOX

PREAMPLIFIER with remote control

- 2 Stereo Line-in
- Motorised volume control
- Premium components and assembly
- SMD for short signal paths
- Gold-plated connections
- Remote control for on/off, input select, and volume
- 12 V trigger function



### AMPBOX Stereo

STEREO POWER AMPLIFIER

- Bi-Phase PWM(Pulse Wave Modulation) circuit
- Discrete design for ultra-dynamic playback and highest resolution
- SMD for short signal paths
- 2 x 30 W@4 ohms/2 x 20 W@8 ohms
- Ultra high-efficiency: approximately 80 % of power consumption goes to "power out"
- Gold-plated, over-sized binding posts
- Trigger-switching with Loop-out



### AMPBOX Mono

MONO POWER AMPLIFIER

- Features as AMP-Box Stereo, by with 1 x 40 W@4 ohms/1 x 28 Watts@8 ohms
- RCA-Loop-out, for Bi-Amping, etc.



PRE-Box and AMP-Box transform the audio quality of Pro-Ject into electronics! With these true audiophile products, we have made a dream come true, one that will attract even more people to listen to high quality music reproduction.

A solid casing forms the outer box, devised for our PHONO-Box, of which we have sold more than 100,000 pcs over the years. Using advanced digital technology that was not available before, high-end sound quality can be achieved. The heart of AMP-Box is a masterpiece of a module of discrete electronics, developed by a small group of audio specialists with over 35 years of experience in audio. The result is authentic sound-staging, the recovery of fine detail and broad dynamics, for lifelike music reproduction in your living room! Compact size and audiophile sound makes ensure that these components are ideal not only for true hi-fi, but also for any applications where small components are required, and which do not over-heat: professional use, home-cinemas or multi-room systems. Easy integration in complex systems is supported with the 12 Volt trigger function.

For audiophile applications, **bi-amping** is of special interest. Many of today's speakers offer separate connections for the high and mid/bass frequencies. Through bi-amping your speakers with two stereo or four mono amplifiers, you can achieve clear advantages in dynamics and openness. Four Boxes side by side provide a standard width of 440 mm, two on top of each other add up to the height of a PHONO-Box SE II or HEAD-Box SE II. Like all Box products, the faceplates are available in black or silver.



Combination [with PC]:

PRE-Box + AMP-Box Stereo + USB-Box  
PC becomes the high-quality source of sound

[devices in proportional ratio]



## PREBOX SE · AMPBOX SE · AMPBOX SE mono

### PREBOX SE

The heart of PRE-Box SE is its single-ended pure Class-A output – a true high-end design. The amplifier stages and power supply are optimised for best audiophile sound quality and use only superior components, resulting in exceptional signal-to-noise ratio and ultra-flat frequency response. Because the output impedance is very low, a wide range of different cables and lengths can be employed

without degrading the signal quality. SMD technology is used for shortest possible signal paths in PRE-Box SE. Its large display can be dimmed, and can be read clearly from a few meters away. You can choose between four line-level inputs and three different outputs, including pre-out, record-out and a special subwoofer-output. PRE-Box SE is equipped with an IR remote.

### AMPBOX SE stereo AMPBOX SE mono

Many music-lovers dream about having powerful audiophile amplifiers that can drive even the most difficult speakers without compromise. AMP-Box SE stereo and AMP-Box SE mono are the ideal solutions when space and budget are limited. For SE versions of AMP-Box, a professional Class-D module is used, one that is able to convert 92 % of AC power into speaker power. Due to its high efficiency, the powerful module does not overheat and can be placed into a very small housing. Sophisticated power supplies and control electronics make the sound of AMP-Box SE Stereo and AMP-Box SE Mono very natural and highly musical. A fully-balanced layout, which usually is not available at this price point, minimises all manner of unwanted signal deterioration caused by interference and switching power supplies. (The signal to noise ratio is >100 dB!) The resultant sound is warm, rich and powerful yet not at all "digital"!

Useful combinations: Best dynamic, spatial playback

PRE-Box SE + AMP-Box SE stereo or



# AMPLIFIER SE

### PREBOX SE

PRE AMPLIFIER with remote control

- 4 Stereo Line-in
- Premium quality components and assembly
- SMD for short signal paths
- Gold plated connections
- Remote control for on/off, input select, and volume
- 12 Volt Trigger



### AMPBOX SE stereo

STEREO POWER AMPLIFIER

- Bi-Phase PWM (Pulse Wave Modulation) circuit
- Discrete design for ultra-dynamic playback and highest resolution
- SMD for short signal paths
- 2 x 125 W@4 ohms/2 x 80 W@8 ohms
- Frequency response: 10 Hz – 50 kHz
- Ultra high-efficiency: approx. 92 % of power consumption goes to "power out"
- Gold-plated, over-sized binding posts
- Trigger-switching with Loop-out



### AMPBOX SE mono

MONO POWER AMPLIFIER

- Features as AMP-Box Stereo, but with 1 x 190 W@4 ohms/110 W@8 ohms
- RCA Loop-out, for Bi-Amping, etc





## AMPLIFIER RECEIVER

### STEREOBOX

INTEGRATED STEREO AMPLIFIER with remote control

- High End preamp, 2 switchable line-level inputs
- High End power amplifier 2 x 30 W@4 ohms/ 2 x 20 W@8 ohms (PWM module)
- SMD design for short signal paths
- Gold-plated connections (RCA & Banana)
- IR remote for volume level and input selection
- Trigger-output for connection with Switch Box



### RECEIVERBOX

INTEGRATED STEREO AMPLIFIER AND FM TUNER with remote control

- High End FM Receiver
- 2 x 30 W@4 ohms/2 x 20 W@8 ohms
- Preamp with 2 stereo Line Inputs
- FM tuner
- High-resolution dot-matrix display (blue)
- Indication of signal strength, precise centre of radio station, stereo/mono reception
- IR remote for volume level and input selection



## STEREOBOX · RECEIVERBOX



### STEREOBOX

Pro-Ject's STEREO-Box is an integrated combination of AMP-Box Stereo and PRE-Box in one small casing. All features of both units can be found in a single unit: remote controlled pre-amplifier with two line-level inputs and an audiophile stereo power amp. Both units share space in a small housing, one which always stays cool due to PWM technique. This miniaturised component offers the same outstanding sound quality of the original modules, which came from Flying Mole. Even though the Stereo Box is very small in size, its sound quality makes it the world's smallest audiophile integrated amplifier!



### RECEIVERBOX

This little wonder in micro-sized hi-fi is composed of a preamplifier, a power amplifier and an FM tuner. They offer the same audio quality and features than PRE-Box, TUNER-Box and AMP-Box. Using the supplied IR remote, you can select inputs and control volume and FM tuner. This ambitious venture was only possible because of large investments to minimise all components without degrading audio quality. A modified and smaller version of the former Flying Mole power amp module makes it possible to produce the only micro-sized FM receiver with real audiophile quality!

### Useful combination – TOP Set #3

DOCK-Box Fi + RECEIVER-Box + SPEAKER-Box 5 [devices in proportional ratio]



## DOCKBOX Fi/Vi · TUNERBOX



### DOCKBOX Fi/Vi

DOCK-Box is the ideal solution to make the iPod part of an audiophile hi-fi system. Dock-Box acts like a perfect buffer amp for the iPod and therefore lowers the distortion level significantly. After passing an initial amplifier section, the signal is transferred to the hi-fi system with an impedance lower than 15 ohms. This guarantees trouble-free signal transmission with ultra-flat frequency response and offers the best, most cost-effective way to build an audio system around an iPod.

#### DOCK-Box Fi

Audiophile version with fixed volume level, which is intended for any existing hi-fi system, highly recommended when linked to PRE-Box, PRE-Box SE, STEREO-Box or RECEIVER-Box.

#### DOCK-Box Vi

employs a built-in volume control for use without a preamplifier, for driving a power amp such as Pro-Ject Amp-Box Stereo. DOCK-Box Vi is a genuine hi-fi bargain, which offers outstanding sound quality.



### TUNERBOX

When the Project FM Tuner is added to Pre Box and Amp Box, it forms a micro-sized receiver system. The simple and clearly arranged display makes this tuner a delight to use. With its full-bodied sound, everyday radio listening turns into pure pleasure!

## SOURCE COMPONENTS

### DOCKBOX

DOCKING STATION for IPOD with charging capability

- Two different versions Vi & Fi
- Discrete audio buffer
- SMD for shortest signal-paths
- Output Impedance >15 Ohm
- Video out
- Flat frequency response 20Hz-20kHz
- Includes remote for playback control
- Charging capability for all iPods including iPhone via 30-pin connector
- USB for iTunes connection



### TUNERBOX

STEREO FM RADIO

- Low-noise FM tuner
- Manual and automatic station calibration
- Adaptive noise reduction
- AFC – automatic centre tuning
- 8 presets
- High-resolution dot-matrix display
- Display of signal strength, centre of station, Stereo/Mono
- Trigger-input with Loop-Out





## SOURCE COMPONENTS

### CDBOX SE

#### High end stereo CD PLAYER in compact format

- 16 bit/44.1 kHz CD Audio playback
- CD, CD-R, CD-RW, and Hybrid SACD playback
- 24 bit/192 kHz DAC from Burr-Brown
- 4-layer suspended CD drive
- "Blue Tiger" Servo-Board for 1:1 CD playback
- Luxurious slot-in mechanism
- High-contrast dot-matrix display
- Solid cabinet protects electronics and drive against vibration
- Gold-plated RCA output connections
- Digital output (RCA)
- External power supply included
- Remote control with volume level adjustment of project amplifiers



### CDBOX

#### Ultra-compact audio CD PLAYER

- 16 bit/44.1 kHz CD Audio playback
- CD, CD-R, CD-RW, Hybrid SACD playback
- Robust and reliable all-metal CD transport
- Slot-in mechanism
- Servo board optimised for 1:1 playback of CDs
- Direct I<sup>2</sup>S digital-interface to DAC
- DAC from Texas Instruments (Burr-Brown)
- External power supply included
- Remote control with volume level adjustment of project amplifiers



### CDBOX DO

similar to CD Box plus digital output connection

## CDBOX SE · CDBOX



### CDBOX SE

A unique audio source component which takes our analogue tradition into the digital world, developed in cooperation with a Vienna-based high tech company, Stream Unlimited, CD-Box SE is a no-compromise CD player, intended exclusively for playback of audio CDs.

Optimised matching of the CD drive mechanism and a specially-designed control board ("Blue Tiger Servo Board") make error correction circuits – which can degrade sound quality – obsolete. Decoupling the drive from the stiff, non-resonating aluminium casing was a crucial concern when designing this product. A four-stage suspended sub-chassis absorbs unwanted vibration from the CD drive. Three soft and one hard suspension layers guarantee accurate read-out of audio CDs. The very best chipsets are used for DA converters (24/192 Burr-Brown) and output stages, providing outstanding sound quality at an remarkably low price level.

Using an external power supply isolates the unit from harmful magnetic fields.

Operation of CD-BOX SE is simplified for intelligent ergonomics: a reduced set of controls appear on the unit for the basic functions, while advanced functionality can be found on the remote, e.g. dimming the display.

**Conclusion:** Special class CD-only player with superlative audio performance!



### CDBOX

CD-only players stand head-and-shoulders above almost all DVD or Blu-ray "universal" players, when it comes to Stereo CD playback. CD-Box and CD-Box SE are built solely to provide the best performance with audio CDs to "Red Book Standard". No Far-East computer drive is used; instead, a robust, high-quality CD transport made in Europe has been fitted to CD-Box. Together with a servo board designed especially for audio CD playback, remarkably low jitter is achieved. Combined with a high-quality, approved DA converter, CD-Box remains true to the original performance, with sound quality that you would not expect at this price level. Using an external power supply isolates the unit from harmful magnetic fields.

## DACBOX FL · DACBOX USB · USBBOX



### DACBOX FL

This first fully digital sound source from Pro-ject BOX-Design started the digital concept series. In contrast to commonly-used, high-bit, manifold oversampling digital-to-analogue converters, DAC-Box FL is a zero-oversampling device without any digital filters. The sound resembles pure analogue, with a lot of warmth and full-bodied presentation not available from high-bit designs, with their cold and soulless sound.

Technically, this concept is solely devoted to the pure audio-only CD format with 16 bit/44.1 kHz upper frequency limit. Four TDA 1543T DACs act in "Dual Differential Mode" and ensure extremely accurate playback and very low distortion levels below 20 kHz. This sort of distortion is very similar to tube amplifiers in character. Above 20 kHz, distortion levels rise rapidly, but this seems to be irrelevant for the human ear. The output stage is direct-coupled to the DAC and uses SMD devices. The sound is natural, stress-free and full of detail, the bass is fast and colourful. For many connoisseurs, this DAC concept is the direct link between the musicians and the ear of the listener!



### DACBOX USB

This 24 bit/96 kHz DA converter uses the latest in processor technology and is suitable for wide range of applications. Three different digital inputs can be selected manually: RCA, Toslink and USB. This high-bit DAC offers more resolution than DAC-Box FL, but will not have the special "something" in audio presentation, as non-oversampling technique can deliver. Sophisticated circuitry layout and SMD technology guarantee extremely low distortion levels and ultra-linear frequency response. The resulting sound of DAC-Box USB is clean, fresh and rich in detail.



### USBBOX

USB-Box is designed for high-quality reproduction of PC audio and connection to a hi-fi system. Typically, computers only offer low-grade audio interfaces. With USB-Box, digital signals can be transferred from PC and converted into analogue audio without losing detail. With USB-Box, a PC can be converted into a high quality audio source for CD and mp3.

## SOURCE COMPONENTS

### DACBOX FL

#### NON-OVERSAMPLING D/A CONVERTER with 2 input options

##### INPUTS:

1 x SPDIF (RCA); 1 x SPDIF optical (Toslink)

##### OUTPUTS:

1 x Stereo RCA

##### DAC:

4 x TDA1543 (parallel, non oversampling, without digital filter stages)

Supported sampling frequencies:

16 bit, 32, 44.1, 48, 96 kHz



### DACBOX USB

#### D/A CONVERTER with 3 switchable inputs

- 3 Inputs (RCA, Toslink, USB)
- Manual switching via button
- 24 bit/96 kHz
- THD <0,005 % (20 Hz-20 kHz)
- >95 dB crosstalk



### USBBOX

#### D/A converter with USB input for PC audio

- High quality D/A conversion
- SMD technology for shortest signal paths
- Output stage with ultra-low impedance
- Automatic detection without the need of additional software, when used with conventional computer systems
- Powered via USB





# PHONO PREAMPLIFIERS

## PHONOBOX II

### PHONO PREAMPLIFIER (MM and MC)

- Preamplifier for MM or MC with switch on the rear panel
- Low-noise ICs



## PHONOBOX II USB

### PHONO PREAMPLIFIER (MM and MC) with USB-output to record music onto PC

- Preamplifier for MM or MC with switch on the rear panel
- Low-noise ICs
- Analogue-out (RCA) & USB Digital-out
- Compatible with Windows®, MacOS® and Linux®

## PHONOBOX II USB V

Same features as PHONO-BOX II USB, plus:

- Digitising line-level inputs (Tape, cassette, etc)
- Phono/Line selector on front panel
- Record level adjustment on front panel



# PHONOBOX II · PHONOBOX II USB | USB V



## PHONOBOX II — A real classic!

Many of today's amplifiers do not have dedicated inputs to match the low output signals of phono cartridges.

PHONO-Box II is the solution – it can be plugged into any line input and is suitable for both MM and MC cartridges. Top quality parts are combined in a class-leading layout with audiophile sound quality at a budget price. Although there is strong competition, Pro-Ject Audio has sold more than 100,000 units! This is a most convincing argument to prove the outstanding quality of this audio product.



## PHONOBOX II USB

Based on PHONO-Box II, it also includes additional Burr-Brown 16-bit Sigma Delta A/D converters to digitise the vinyl signal for transferring to a computer. It can be used with Windows®, MacOS® and Linux® operating systems. PHONO-Box II USB will be recognised automatically as a soundcard by most operating systems. There are numerous inferior "low cost" rivals on the market, but we think the listener deserves real hi-fi sound for the lowest possible price!

## PHONOBOX II USB V

Similar to PHONO-Box II USB, but with two additional functions: line-level recording and manual recording level adjustment. Owners of open-reel and cassette tape machines will be overjoyed with the possibility of transferring analogue tape to digital with the best quality possible. Recording level can be adjusted manually on the front of PHONO-Box USB V. This high quality device can be used in parallel with a hi-fi system and computer.

### Useful combination [with PC]:

Plattenspieler „DEBUT III“ [silver] + PHONO-Box USB V  
Music recording from LP's to PC and save the digital file.



# TUBEBOX SE II · TUBEBOX II · PHONOBOX SE II



## TUBEBOX SE II

PHONO-Box SE II and TUBE-Box SE II share a similar design concept. Only the adoption of highest grade audiophile components makes the superior performance of TUBE-Box SE II possible.

In TUBE-Box SE II, OPA2134 ICs in the input section do not lose even a trace of detail. A newly-designed power supply and SMD technology drastically reduce noise levels. Premium ECC803S output tubes, together with direct mounted EAT Cool Dampers (cooling and damping of resonances), deliver uncom-

promised sound quality. TUBE-Box SE II shares the same warmth and musicality of TUBE-Box II, but offers more openness, and more subtle dynamics, with astounding levels of resolution! TUBE-Box SE II is a true high end bargain!

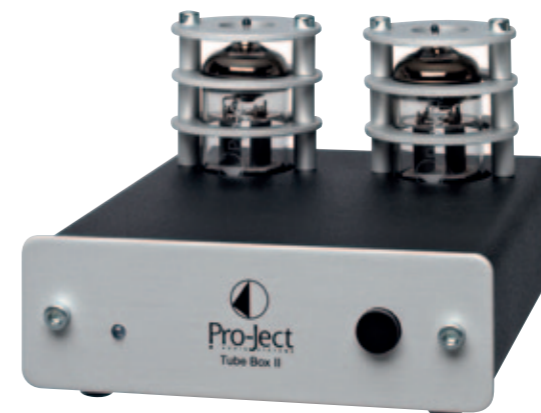

## TUBEBOX II

TUBE phono preamplifier for MM and MC that reproduces music with matchless sympathy. Powerful and lifelike, passionate and highly emotional – these are attributes to describe the sound of TUBE-Box II.

## PHONOBOX SE II

PHONO-Box SE II is a totally new design that lifts the performance to an even higher level. A premium chipset, a beefier power supply and the highest grade components form the basis of this audio marvel. It uses five parallel OP-amps for each channel. Using SMD technology, the signal paths are reduced dramatically. The result is optimum sound quality and minimised levels of noise and distortion. Mini switches are used to adjust capacity, inductance and subsonic filtering. PHONO-Box SE II enjoys a clear sonic advantage over the standard PHONO-Box II.



# PHONO PREAMPLIFIERS

## TUBEBOX SE II

### TUBE PHONO PREAMPLIFIER (MM and MC)

- Preamplifier for MM or MC with switches on the rear panel
- Impedance switch for MC cartridges
- Capacitance switch for MM cartridges
- Subsonic filter switchable
- Dual-mono architecture
- Premium ECC803 Golden Pin tubes
- EAT CoolDampers for protection against unwanted vibration
- High End Chipset for optimum sound
- Ultra low-noise semiconductors
- SMD technology



## TUBEBOX II

### TUBE PHONO PREAMPLIFIER (MM and MC)

- Preamplifier for MM or MC with switch on the rear panel
- Subsonic filter, switchable
- Dual-mono architecture with 2 double triode tubes for optimum channel separation
- Ultra low-noise semiconductors



## PHONOBOX SE II

### PHONO PREAMPLIFIER (MM and MC)

- Preamplifier for MM or MC with switches on the rear panel
- Impedance switch for MC cartridges
- Capacitance switch for MM cartridges
- Dual-mono architecture
- Ultra low-noise ICs
- SMD technology
- DC power possible (e.g. with rechargeable batteries)





## SPEEDBOX · SPEEDBOX SE

### SPEEDBOX II

**ELECTRONIC SPEED CONTROL**  
with switch (33/45 rpm) for Pro-Ject and other turntables

- Suitable for turntables with wall AC power supply (16 V/AC synchronous motor)
- Quartz-controlled speed, switchable between 33 rpm and 45 rpm
- Microprocessor-controlled
- For superior smoothness of drive motor



### SPEEDBOX SE II

**ELECTRONIC SPEED CONTROL**  
with switch (33/45 rpm) for Pro-Ject and other turntables

- Same features as SPEED-Box II, but for 230 V and 16 V AC
- Fine adjustable motor speed in ± 20 steps
- Digital display in blue colour
- Ultra-stable voltage with mains filter



#### ADDITIONAL information for SPEED-Box II/SPEED-Box SE II:

With turntable Pulley SB (accessory) used with SPEED-Box II or SPEED-Box SE II, the following models can operate at 33/45/78 rpm:

RPM 5 · 1-Xpression · Debut III · Debut SE II & Debut III Esprit



### SPEEDBOX II

SPEED-Box II is a truly useful add-on for Pro-Ject turntables without electronic speed control. With a single push of a button turntable, speed can be switched between 33 rpm and 45 rpm, without touching the platter or drive belt. Additionally the quartz-controlled power with built-in mains filter offers better smoothness for the motor.



### SPEEDBOX SE II

SPEED-Box SE II offers an even better performance as an electronic speed control and is also suitable for 230 V driven turntables. Its advanced circuitry generates an ultra-stable power supply that is virtually free from noise. This leads to vibration-free smoothness of turntable motors, and therefore gets out the best sound reproduction from your record player.

#### Combination:

SPEED-Box SE + Turntable RPM 9.1  
[devices in proportional ratio]



## HEADBOX II · HEADBOX II SE



### HEADBOX II

Most integrated amplifiers have inferior headphone amps or do not have a headphone socket at all. HEAD-Box II offers high-performance headphone amplification with volume control. It can be connected to any integrated or preamplifier.



### HEADBOX SE II

As with PHONO-Box SE, sound quality was the main concern in this newly-devised HEAD-Box SE II. High-end components like Burr-Brown chipsets, advanced power supply circuitry and SMD technology provide the best technical capabilities with excellent audio quality. Two headphone sockets with individual volume controls are provided. Despite the true high-end sonic qualities both, Pro-Ject headphone amplifiers are genuine bargains!

#### Useful combination – TOP Set #5

DOCK-Box Fi + HEAD-Box II + DESIGN-Box 2 iP [Colour: olive]  
[devices in proportional ratio]



### HEADBOX II

#### HEADPHONE AMPLIFIER

- Socket for one headphone with volume control
- Low noise semiconductors
- RCA-Loop-Outputs



### HEADBOX SE II

#### AMPLIFIER FOR 2 HEADPHONES

- Two headphone sockets with individual volume controls
- Ultra low-noise semiconductors from Burr-Brown
- SMD technology for short signal paths
- Signal to noise ratio -120 dB
- THD <0.0014 % THD
- RCA-Loop-Outputs





## ACCESSORIES

### SWITCHBOX

INPUT EXTENSION FOR AMPLIFIERS  
[Pro-Ject Audio or others]

- 4 inputs, which provides an extra three-input expansion for PRE-Box
- Ultra-low crosstalk
- 2 line outputs for separate usage
- Automatic synchronisation with trigger cable of PRE-Box
- Input expansion, suitable also for all other brands



### POWERBOX II

CENTRAL POWER SUPPLY for units of the BOX family and Pro-Ject turntables

- Up to 4 different units connectable simultaneously (16 V/AC)
- No separate power supplies needed
- Individual power switching
- Maximum power surge is 1A



### PS4-WAY (2A)

CENTRAL POWER SUPPLY for units of the BOX family and Pro-Ject turntables

- Up to 4 different units can be connected simultaneously (16 V/AC)
- Suitable for all Box design components except: AMP-Box Stereo, AMP-Box Mono, AMP-Box SE Stereo, AMP-Box SE Mono, STEREO-Box, RECEIVER-Box, JUKEBOX (these need 20 Volt DC power)
- No separate power supplies needed
- Maximum power surge is 2 A, because CD-Box, CD-Box SE, TUBE-Box, TUBE-Box SE have a very high power surge. We recommend connecting only two of these to one PS4-way (2 A) – please read detailed product information!

## SWITCHBOX · POWERBOX · PS4-WAY



### SWITCHBOX

Pro-Ject SWITCH-Box is a cost-effective extension of a PRE-Box to add another three inputs with an additional stereo-out, with the least possible manipulation of the original signal. Crosstalk from left to right channel @1 kHz is better than 107 dB. Frequency response is ultra-flat up to 700 kHz.

Pro-Ject SWITCH-Box can be controlled manually and therefore it also can be used with any other hi-fi system.

Using SWITCH-Box with Pro-Ject PRE-Box, input switching can be performed over the remote control, when a trigger cable is plugged in.



### POWERBOX II

As a central power supply for up to four units of the BOX family or turntable, POWER-Box II is a practical solution with best sonic quality. Each unit can be switched on/off individually. Instead of using four individual power supplies only one is needed to get optimised power with constant voltage, including mains filter. Suitable for all Pro-Ject turntables and BOX-Design products, except AMP-Box, AMP-Box Mono, AMP-Box SE Stereo, AMP-Box SE Mono, STEREO-Box and RECEIVER-Box.

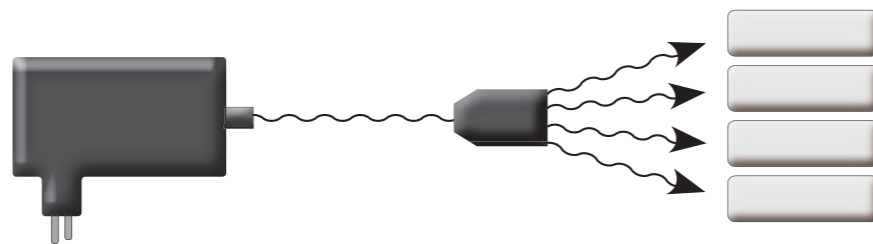

### PS4-way (2 A)

Central power supply for up to four units of the Box family or turntable, PS4-way is suitable for Pro-Ject turntables and BOX-Design products, except AMP-Box, AMP-Box Mono, AMP-Box SE Stereo, AMP-Box SE Mono, STEREO-Box and RECEIVER-Box.

## JUKEBOX



### JUKEBOX

Pro-Ject JUKEBOX fulfils the longing of many vinyl lovers, to have an "ALL-IN-ONE" system that is able to provide smart design and outstanding audio quality.

In its beautiful and compact casing, the following components are included:

TT-DEBUT III + PRE-Box + PHONO-Box + SWITCH-Box + AMP-Box Stereo incl. remote control

### JUKEBOX ESPRIT

Luxury version of JUKEBOX with same features, but acrylic platter.

Just connect some good-quality speakers – like SPEAKER-Box 5 – and listening pleasure is guaranteed!

### Useful combination – TOP Set #10

DOCK-Box Fi + TUNER-Box II + DESIGN-Box 2 iP + SPEAKER-Box 5



## ALL-IN-ONE PHONO SYSTEM

### JUKEBOX

Audiophile ALL-IN-ONE stereo system with turntable

- Belt-drive turntable with manual speed change 33/45 rpm
- MM cartridge
- Phono preamplifier
- Line preamplifier with 4 inputs
- Power amplifier (bi-phase PWM), 2 x 30 W@ 4 ohms/2 x 20 W@8 ohms
- 90 % energy efficiency
- Oversized gold-plated speaker terminals
- IR remote for on/off, input selection and volume level





### SPEAKERBOX 5

#### 2-way MONITOR SPEAKER

- Bass-reflex principle
- 25 mm silk-dome tweeter
- 130 mm bass-mid driver
- 55 Hz-20 kHz frequency response
- 8 ohm impedance
- 86 dB efficiency (1 W/1 m)
- 10 W-150 W suggested amplifier power
- Magnetic screening of chassis
- Wall-mount included
- High-gloss piano lacquer finish in 3 colours: black, white, red
- Black cloth speaker grill with magnetic fittings
- Dimensions: 228 x 228 x 200 mm (w x h x d)
- Weight: 4.2 kg



### WALL BRACKET [2 pcs]

for SPEAKER-Box



### SPEAKER Box 5

Audiophile 2-way monitor speaker using bass reflex system, tight and clear bass, reflex port on back side, outstanding value for money, ideal for use with other BOX-Design components, high-gloss piano lacquer finish in three colours: black, white, red

### SPEAKER Box 4

Audiophile 2-way mini monitor speaker. Coming soon!

#### Useful combination – TOP Set #6

DOCK-Box Fi + RECEIVER-Box + CD-Box + DESIGN-Box 4 iP + SPEAKER-Box 5  
Digital and similar tone sources for optimally enjoy



### CONNECT-it NF

Connect-it signal cables from Pro-Ject are optimised for use with phono signals. This means they are very flexible, and have low capacitance. With their parallel symmetric assembly and perfect screening these cables are technically accurate and give neutral sound without coloration.

With the exclusive application of state-of-the-art European components for conductors and dielectric, with precision craftsmanship, we supply only the best quality. RCA-plugs were selected after intense mechanical examination and listening tests.

All available lengths were chosen for best performance regarding the specific speed of electrical signals in cables.

Our strict commitment to high quality standards make the Connect-it cable program the first choice for a lossless connection between all Pro-Ject Box components.

Connect-it is available in different lengths to suit various applications.

Very short cables of 0.2 and 0.4m lengths avoid tangled cable with micro components like Pro-Ject Box Design. We also offer longer versions up to 4.92m that are especially of interest for bi-amping applications, where amplifiers are positioned near the speakers. Connect-it cables are very cost-effective, compared to Far Eastern products, and will offer significantly better sonic quality.

### CONNECT-it LS

The Legend Pro-Ject cable – Made in Europe!

This sophisticated speaker cable uses solid-core technology with spiral geometry. Most high-end cable manufacturers use solid-core technology and spiral geometry because of superior performance and very low capacitance and inductance. High purity oxygen-free copper (HP-OFC), the best dielectric, which isolate all four conductors from each other, make this economically-priced cable a “best buy” solution and an ideal partner for Box Design components

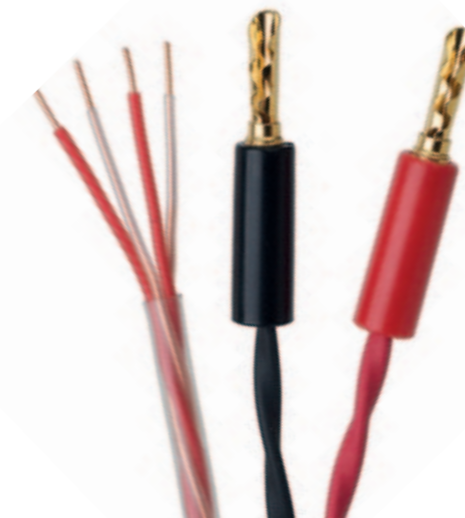

### CONNECT-IT RCA C

pure OFC (oxygen free copper)

### CONNECT-IT RCA SI

pure silver for best performance

#### Connect-it RCA common features

- 2 RCA > 2 RCA Interconnect
- Top-quality pure conductors
- European manufacturing
- Double symmetric assembly
- Low capacitance
- Efficient screening to avoid interference
- High quality, flexible dielectric
- Silver-plated contacts
- Available in 0.205 | 0.41 | 0.82 | 1.23 | 1.85 | 2.46 | 4.92 meter lengths
- 0.82 | 1.23 | 1.85 includes earth lead

### CONNECT-IT LS

#### AUDIOPHILE LOUDSPEAKER CABLE

- Solid-core technology
- HP-OFC conductors
- European manufacturing
- Low inductance
- Low capacitance
- Available in bulk on spools



## ACCESSORIES

### DESIGN BOX 2 & 4 DESIGN BOX 2 iP & 4 iP

#### DESIGNED FRAMES for BOX-Design components

Dimensions (w x h x d):  
DESIGN-Box 2/2 iP: 11,8 x 8,8 x 20,0 mm  
DESIGN-Box 4/4 iP: 22,0 x 8,8 x 20,0 mm

STANDARD COLOURS:  
BLACK, WHITE, RED, OLIVE, MAHOGANY  
NON STANDARD COLOURS, only on demand:  
YELLOW, GREEN, BLUE, BEECH, ROSEWOOD



## AZURRACKS & DESIGNBOX VARIATIONS

### AZUR MICRO RACKS

The beautiful AZUR Micro Racks are made of satin acrylic are easily used in combinations. Three different types, "The BUTLER", "The PROFESSIONAL" and "The LADY" (from left to right & below) are offered in a variety of colours and three different heights (2, 3, 4 units stacked) with standard or double widths. LED lights can be added on demand.

Further informations under: <http://the-rack.at>



Photos: ©Nahaufnahme/Regine Haunschmidt



### DESIGN BOX 2 & 4 | 2 iP & 4 iP

Shapely designed frame for Box Design components for two of the "small" units on top of each other or one unit of the SE series.

"4" is suitable for four of the "small" units – two side by side and two on top, or two units of the SE-series. Using iP versions, an iPod or iPhone can be easily fitted.

Available in many fashionable colours for perfect integration of your BOX-Design components into your home.

## TECHNICAL DATA

Page   Type	Trigger 12 Volt DC (2,5 mm Jack plug)	Power pack	Remote control	Dimensions incl. sockets w x h x d (in mm)	Weight without PP
04 PRE-Box	Out + Switch Box	16 Volt AC/500 mA	yes	103 x 36 x 109	630 g
04 AMP-Box Stereo	In	20 Volt DC/3 A	-	103 x 36 x 122	670 g
04 AMP-Box Mono	In	20 Volt DC/3 A	-	103 x 36 x 122	670 g
05 PRE-Box SE	Out + Switch Box	16 Volt AC/500 mA	yes	103 x 72 x 144	1.200 g
05 AMP-Box SE Stereo	In	48 Volt DC/2,5 A	-	103 x 72 x 163	1.400 g
05 AMP-Box SE Mono	In	48 Volt DC/2,5 A	-	103 x 72 x 163	1.400 g
06 STEREO-Box	-	20 Volt DC/3 A	yes	103 x 36 x 122	720 g
06 RECEIVER-Box	Switch-Box	20 Volt DC/3 A	yes	103 x 36 x 122	670 g
07 DOCK-Box Vi/Fi	-	16 Volt AC/200 mA	yes	103 x 36* x 109	585 g
07 TUNER-Box	In & Out	16 Volt AC/200 mA	-	103 x 36 x 112	565 g
08 CD-Box	-	16 Volt AC/1 A	yes	206 x 36 x 156	1.200 g
08 CD-Box SE	-	16 Volt AC/1 A	yes	206 x 72 x 200	2.670 g
09 DAC-Box FL	-	16 Volt AC/500 mA	-	103 x 36 x 109	560 g
09 DAC-Box USB	-	16 Volt AC/500 mA	-	103 x 36 x 109	560 g
09 USB-Box	-	USB powered	-	103 x 36 x 109	540 g
10 PHONO-Box SE II	-	16 Volt AC/1 A	-	103 x 72 x 156	1.080 g
10 PHONO-Box II	-	16 Volt AC/200 mA	-	103 x 36 x 115	570 g
10 PHONO-Box USB II	-	16 Volt AC/200 mA	-	103 x 36 x 115	570 g
10 PHONO-Box USB V	-	16 Volt AC	-	103 x 36 x 115	580 g
11 TUBE-Box SE II	-	16 Volt AC/1 A	-	103 x 76 x 156	1.050 g
11 TUBE-Box II	-	16 Volt AC/1 A	-	103 x 74 x 137	810 g
12 SPEED-Box SE II	-	16 Volt AC/1°	-	103 x 72 x 144	1.360 g
12 SPEED-Box II	-	16 Volt AC/500 mA	-	103 x 36 x 103	540 g
13 HEAD-Box II	-	16 Volt AC/500 mA	-	103 x 36 x 109	600 g
13 HEAD-Box SE II	-	16 Volt AC/1 A	-	103 x 72 x 150	1.080 g
14 SWITCH-Box	In	16 Volt AC/200 mA	-	103 x 36 x 109	560 g
14 POWER-Box II	-	16 Volt AC/1 A	-	103 x 36 x 103	545 g
15 JUKE Box	-	16 Volt AC + 21 Volt DC	-	415 x 118 x 350	6.900 g
16 SPEAKER-Box 5	-	-	-	160 x 255 x 210	4.200 g

#### COMMON FEATURES for all Box-Design components:

- Solid and compact casing that protects against vibration and radiation
- Gold-plated RCA connectors
- Black or silver faceplate
- Separate power supply (included)



# TOP 10 – SYSTEM COMBINATIONS [1 – 6]

# TOP 10 – SYSTEM COMBINATIONS [7 – 10] + MULTIROOM

**Top Set #1:**  
Top-quality sound from iPod

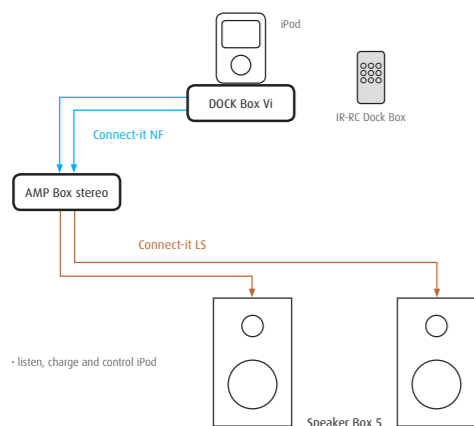

**Top Set #2:**  
Listening iPod in high-end quality

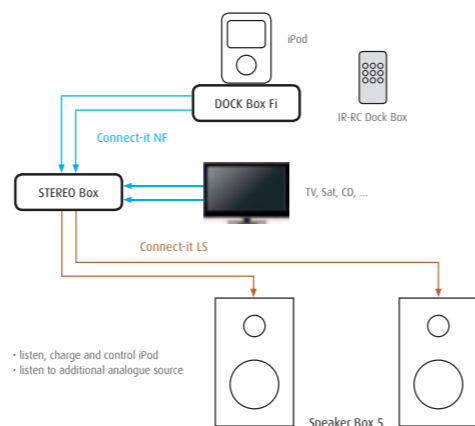

**Top Set #7:**  
listen to iPod, radio and music from PC; digital recording of vinyl-LPs

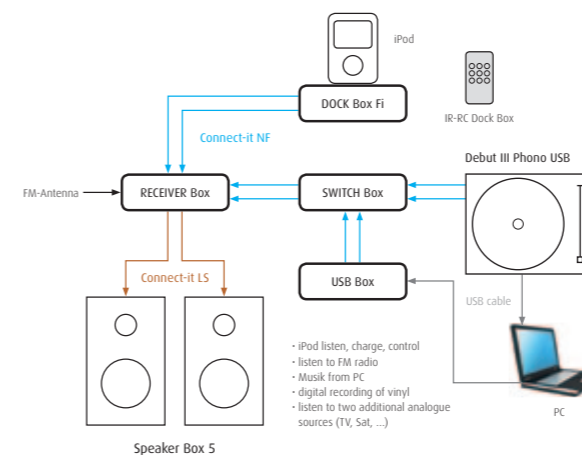

**Top Set #8:**  
Music from iPod, PC and other digital sources

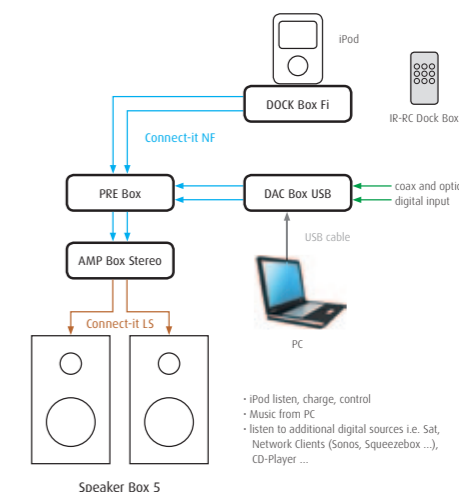

**Top Set #3:**  
Listen to iPod and radio

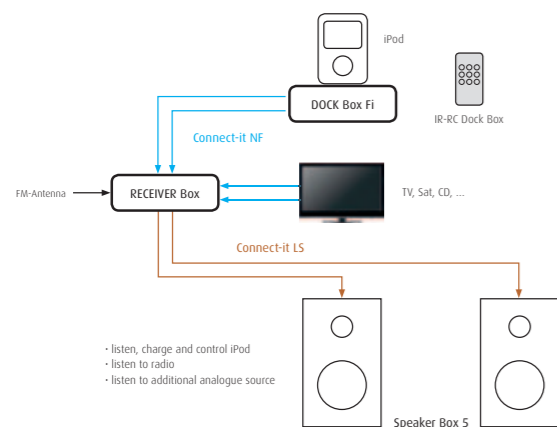

**Top Set #4:**  
Music from PC/mp3-server in hifi quality

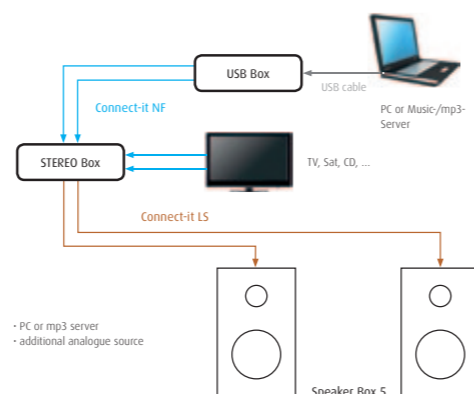

**Top Set #9:**  
Listen to vinyl

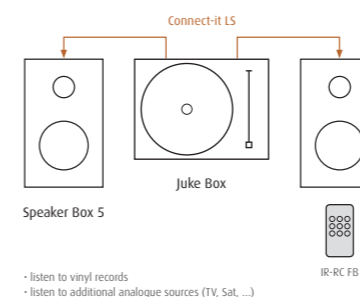

**Top Set #10:**  
Listen to vinyl, radio, iPod

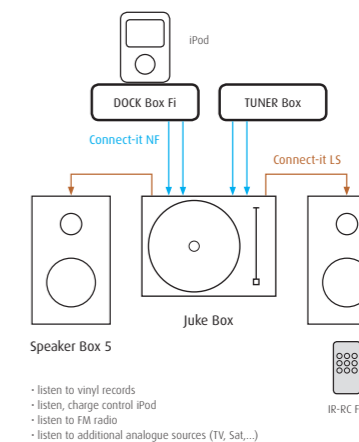

**Top Set #5:**  
Listening to iPod-music on headphones

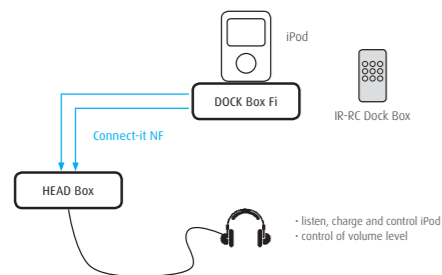

**Top Set #6:**  
Listening to iPod, CD, FM-radio

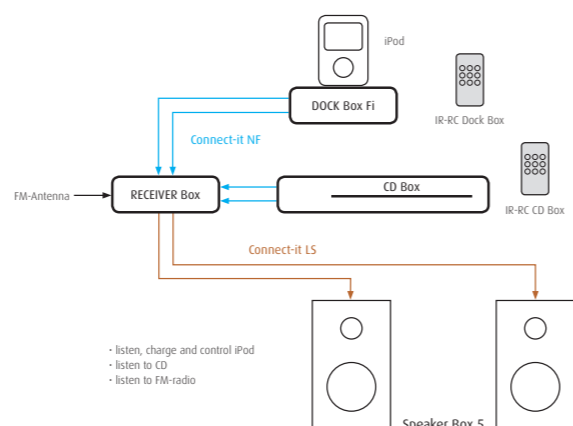

**Box-Design Multiroom solution:**  
Hifi quality music in multiple zones

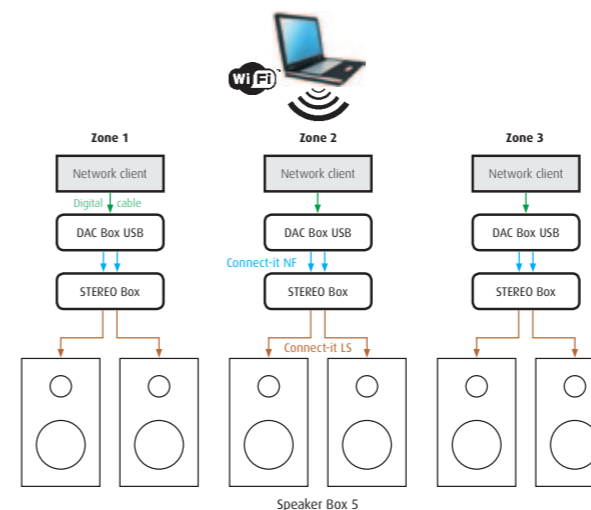

- top quality music reproduction from PC in multiple zones
- optimised sound from network clients, like Sonos, Squeezebox, Airport Express, ...
- maximum of zones depends on manufacturer of network and clients
- listen to additional analogue sources (TV, Sat, ...)

Cutline:  
Connect-it NF is low-frequency signal cable (colour blue)

Connect-it LS is speaker cable (colour brown)

USB cables (colour grey)

Digital source connection = coax or optical (colour green)

More information about Connect-it cables see page 17